

# DRAWING NOTES

- DIVISION 3: CONCRETE**
- 3.01 ADD ALTERNATE 6: (N) CONCRETE COURTYARD DECK, SLOPED MIN 2% TO THROUGH-WALL SCUPPER, TYP. (N) TERRA COTTA TILE TO MATCH (E), TYP.
- DIVISION 6: WOOD & PLASTICS**
- 6.01 (N) WOOD FRAMING AND SHEATHING TO REPLACE (E) FRAMING & SHEATHING REMOVED DURING DESTRUCTIVE TESTING, TYP.
- 6.02 CONTRACTOR TO NOTIFY OWNER'S REPRESENTATIVE IF (E) FRAMING & SHEATHING IS DAMAGED BY WATER INTRUSION AND DRY ROT; WATER AND DRY ROT DAMAGED FRAMING AND SHEATHING SHALL BE REPLACED AT THE OWNER'S REPRESENTATIVE'S DISCRETION ON A UNIT PRICE BASIS, TYP.
- 6.03 (N) PRESSURE TREATED WOOD SILLS AT (E) FRENCH DOORS & WINDOWS, TYP. (E) FRENCH WINDOW SILL TO BE RAISED TO A FINISH HEIGHT OF 4" A.F.F.
- 6.04 INSTALL CONTINUOUS (N) PRESSURE-TREATED WOOD SHIMS UNDER ALL (N) COPINGS; SHIM AS REQUIRED TO ACHIEVE MIN 2% SLOPE ON ALL HORIZONTAL SURFACES OF (N) COPINGS, TYP.
- DIVISION 7: THERMAL & MOISTURE PROTECTION**
- 7.01 CONTRACTOR SHALL TAKE ALL PRECAUTIONS NECESSARY TO PROTECT ALL UNDERLYING (E) WEATHER-RESISTIVE BARRIERS IN PLACE DURING REMOVAL OF (E) EXTERIOR PLASTER SYSTEM WHERE NEW COMPONENTS ARE INSTALLED, TYP.
- 7.02 INSTALL (N) PEDESTRIAN TRAFFIC COATING OVER (E) PLYWOOD SHEATHING AT 2ND FLOOR DECK, TYP. INSTALL (N) COATING INTO (N) FLANGED DECK DRAIN BOWL & SEAL ALL PENETRATIONS THROUGH (N) COATING WITH MANUFACTURER APPROVED SEALANT, TYP. SLOPE (E) SHEATHING AS REQUIRED TO ACHIEVE MINIMUM 2% SLOPE TO DRAIN, TYP.
- 7.03 (N) CONCRETE ROOF TILES TO MATCH (E) OVER 2 LAYERS MECHANICALLY FASTENED (N) SBS-MODIFIED SHEET ROOFING MEMBRANE, TYP. (N) SHEET ROOFING MEMBRANE SHALL BE INSTALLED IN A SHINGLE FASHION WITH MINIMUM 12" OVERLAP; FASTEN PER MANUFACTURER'S REQUIREMENTS, TYP.
- 7.04 INSTALL (N) FULLY-ADHERED SINGLE-PLY PVC ROOFING MEMBRANE AT ALL LOW SLOPE ROOF AREAS AND UNDERNEATH (E) SOLAR PANELS, TYP. ALL (N) SINGLE-PLY ROOFING MEMBRANE AND ASSOCIATED TRANSITIONS AND FLASHING SHALL BE FROM A SINGLE MANUFACTURER, TYP. MODIFY (N) ROOF SHEATHING AS REQUIRED TO ACHIEVE MINIMUM 2% SLOPE TO DRAIN, TYP.
- 7.05 ALL (N) SHEET METAL SHALL BE 24 GA STAINLESS STEEL UNLESS OTHERWISE NOTED, PAINTED TO MATCH ADJACENT WALL, TYP.
- 7.06 INSTALL (N) 24 GA STAINLESS STEEL HEAD FLASHINGS & SILL PANS AT ALL WINDOW & DOOR LOCATIONS, TYP. ALL (N) HEAD FLASHINGS & SILL PANS CORNERS TO BE WELDED, TYP. FLASH ALL WINDOW & DOOR OPENINGS WITH (N) SELF-ADHERED FLASHING MEMBRANE, TYP.
- 7.07 (N) 24 GA STAINLESS STEEL SCUPPER & DOWNSPOUT ASSEMBLY TO REPLACE (E) INTERNAL ROOF DRAIN SYSTEM, TYP. PAINT (N) SCUPPER & DOWNSPOUT TO MATCH (N) WALL FINISHES, TYP. PROVIDE BLOCKING AS REQUIRED FOR (N) DOWNSPOUT SUPPORTS; SEAL (N) FASTENER PENETRATIONS THROUGH WEATHERPROOFING MEMBRANES WITH APPROVED SEALANT, TYP.
- 7.08 INSTALL (N) SELF-ADHERED FLASHING MEMBRANE UNDERNEATH PARAPET COPINGS & SILL PANS, OVER AND UNDER ALL SHEET METAL TRANSITIONAL FLASHINGS, PENETRATION FLASHINGS, WEEP SCREEDS, & SCUPPERS; AND AROUND ALL EXTERIOR VENT, WINDOW, DOOR AND OTHER OPENINGS, TYP. (N) SELF-ADHERED FLASHING SHALL BE INSTALLED IN A SHINGLE FASHION, TYP.
- 7.09 SEAL ALL PENETRATIONS THROUGH WEATHERPROOFING MEMBRANES, INCLUDING (N) OR (E) WEATHER RESISTIVE BARRIER, DECK COATING, AND ROOFING MEMBRANE WITH A MANUFACTURER APPROVED SEALANT, TYP.
- DIVISION 8: WINDOWS & DOORS**
- 8.01 (N) WATER-MANAGED VINYL-CLAD WOOD WINDOW & FRAME SYSTEM; FACTORY FINISHED, COLOR TO MATCH (E), TYP. MODIFY (E) FRAMING AS REQUIRED TO INSTALL (N) WINDOW SYSTEM, TYP. ADD-ALTERNATE 5: (N) ALUMINUM-CLAD WOOD WINDOW SYSTEM IN LIEU OF VINYL-CLAD WINDOW SYSTEM.
- 8.02 (N) WATER-MANAGED VINYL-CLAD WOOD DOOR & FRAME SYSTEM; FACTORY FINISHED, COLOR TO MATCH (E), TYP. MODIFY (E) FRAMING AS REQUIRED TO INSTALL (N) DOOR SYSTEM, TYP. ADD-ALTERNATE 5: (N) ALUMINUM-CLAD WOOD DOOR SYSTEM IN LIEU OF VINYL-CLAD DOOR SYSTEM.
- 8.03 (N) WATER-MANAGED HOLLOW METAL DOOR & FRAME SYSTEM WITH INTEGRAL LOUVERED VENT; FACTORY FINISHED, COLOR TO MATCH (E), TYP. MODIFY (E) FRAMING AS REQUIRED TO INSTALL (N) DOOR SYSTEM, TYP.
- 8.04 (N) WATER-MANAGED SKYLIGHT SYSTEM; FACTORY FINISHED, COLOR TO MATCH (E), TYP. MODIFY (E) FRAMING AS REQUIRED TO INSTALL (N) SKYLIGHT SYSTEM, TYP.
- DIVISION 9: FINISHES**
- 9.01 REMOVE (E) WALL FINISHES AS REQUIRED TO INSTALL NEW COMPONENTS, INCLUDING BUT NOT LIMITED TO (N) WINDOW & DOOR SYSTEMS, (N) TRELLIS SUPPORTS, (N) VENT ASSEMBLIES, (N) DRAINAGE COMPONENTS, (N) WEEP SCREEDS AND (N) FLASHINGS, TYP. CONTRACTOR SHALL PROTECT (E) UNDERLYING WATERPROOFING MEMBRANE IN PLACE UNLESS SPECIFICALLY NOTED OTHERWISE, TYP. INSTALL (N) FINISHES TO MATCH (E) WHEN NEW COMPONENT INSTALLATION IS COMPLETE, TYP.
- 9.02 (N) ACRYLIC FORTIFIED PLASTER FINISH OVER (E) EXTERIOR PLASTER SCRATCH & BROWN COATS; PREPARE (E) PLASTER SYSTEM TO RECEIVE (N) FINISH PER COATING MANUFACTURER'S REQUIREMENTS, TYP. CONTRACTOR SHALL PROTECT (E) BUILDING COMPONENTS THAT ARE TO REMAIN IN PLACE DURING (N) PLASTER FINISH INSTALLATION, TYP.
- 9.03 REMOVE (E) INTERIOR WALL FINISHES AS REQUIRED TO INSTALL NEW COMPONENTS, INCLUDING BUT NOT LIMITED TO (N) WINDOW & DOOR SYSTEMS, TYP. INSTALL (N) INTERIOR FINISHES TO MATCH COLOR & FINISH PROFILE OF (E) FINISHES, TYP.
- 9.04 (E) ACRYLIC FORTIFIED PLASTER FINISH COAT OVER (E) SCRATCH & BROWN PLASTER COATS; REMOVE (E) FINISH COAT & PREPARE (E) SCRATCH & BROWN COATS PER (N) FINISH COAT MANUFACTURER'S REQUIREMENTS, TYP. CONTRACTOR TO PROTECT (E) BUILDING COMPONENTS THAT ARE TO REMAIN IN PLACE DURING (E) EXTERIOR PLASTER INSTALLATION, TYP.
- DIVISION 10: SPECIALTIES**
- 10.01 INSTALL (N) LOUVERED WALL VENTS IN (E) VENT LOCATIONS; MODIFY (E) OPENINGS AS REQUIRED TO INSTALL (N) VENTS, TYP.
- 10.02 CONTRACTOR SHALL REMOVE, STORE & PROTECT ALL MISCELLANEOUS (E) WALL MOUNTED FIXTURES INCLUDING (E) SIGNS & NUMBERS AS REQUIRED TO COMPLETE REPAIRS & (N) FINISH INSTALLATIONS, TYP. REMOVED ITEMS SHALL BE CLEANED AND REINSTALLED AT (E) LOCATIONS AFTER REPAIRS AND (N) FINISH INSTALLATIONS ARE COMPLETE; SEAL ALL PENETRATIONS IN WEATHERPROOFING MEMBRANES WITH APPROVED SEALANT, TYP.
- DIVISION 13: SPECIAL CONSTRUCTION**
- 13.01 REMOVE, STORE & PROTECT (E) SOLAR PANELS DURING INSTALLATION OF (N) ROOFING SYSTEM, TYP. INSTALL (N) SOLAR PANEL SUPPORTS PER STRUCTURAL ENGINEER'S REQUIREMENTS AND FLASH ROOFING SYSTEM PENETRATIONS PER ROOFING SYSTEM MANUFACTURER'S REQUIREMENTS, TYP.
- 13.02 ALL PENETRATIONS THROUGH FIRE-RATED ASSEMBLIES SHALL BE SEALED WITH A COMPATIBLE FIRE-STOP COMPOUND, TYP.
- DIVISION 15: MECHANICAL & PLUMBING**
- 15.01 FASTEN ALL ROOF DRAIN FLANGES TO SUBSTRATE AS REQUIRED BY (N) ROOFING SYSTEM & (N) PEDESTRIAN TRAFFIC COATING SYSTEM MANUFACTURER'S REQUIREMENTS TO PREVENT DAMAGE TO (N) ROOFINGS & COATING SYSTEMS AT DRAIN FLANGE EDGES, TYP.
- 15.02 (N) ROOF DRAINS SHALL BE CONNECTED TO (N) EXTERNAL DOWNSPOUT PIPES, TYP.
- DIVISION 16: ELECTRICAL**
- 16.01 REMOVE, STORE & PROTECT (E) WALL MOUNTED FIXTURES DURING CONSTRUCTION, TYP. REINSTALL AT (E) LOCATIONS WHEN INSTALLATION OF (N) WALL FINISHES IS COMPLETE; SEAL PENETRATIONS THROUGH (N) OR (E) WEATHERPROOFING MEMBRANES WITH APPROVED SEALANT, TYP.

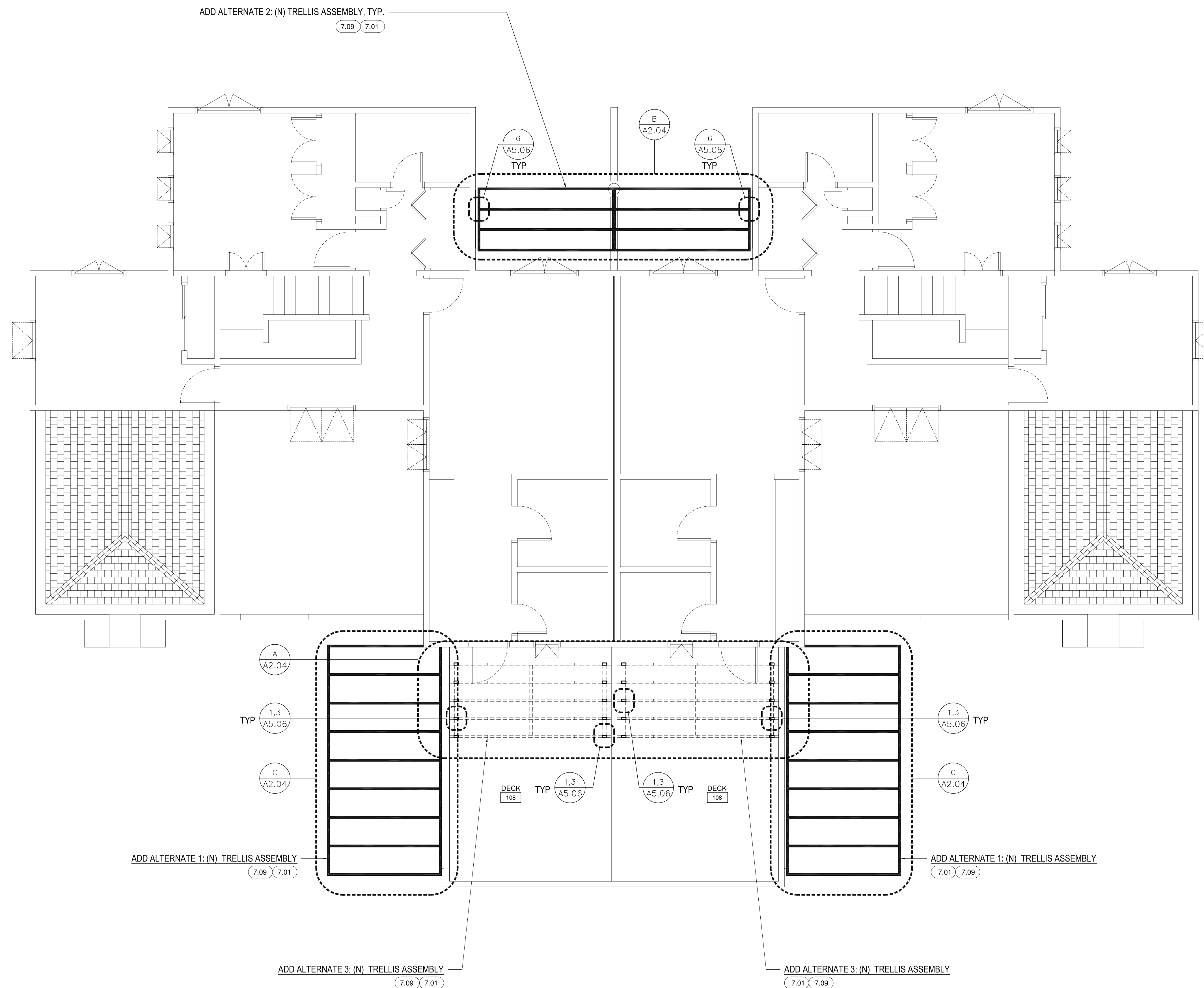

UNIT 918

UNIT 917

## A ADD-ALTERNATE SECOND FLOOR PLAN

SCALE: 1/4"=1'-0"